



# Dongguan Tianrui Electronic Co., Ltd

Add:#201, No.1 Building, No.9 Chashan Part, Guanlong Road,  
Chashan Town, Dongguan City, Guangdong, China 523399

Tel:+86-769-82398812

Fax:+86-769-82398816

Email: techrich@vip.163.com

http://www.fuse-china.com/

**51 (T1)  
auto reset**

**54 (T3)  
manual reset**

**55 (T3+switch)**

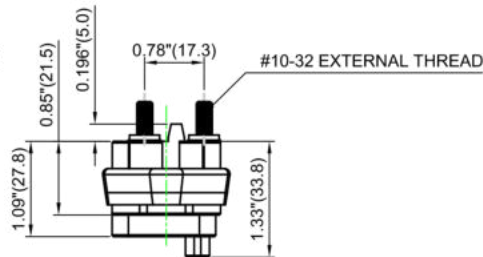
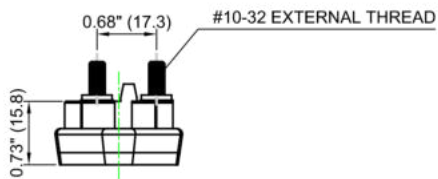
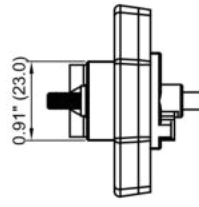
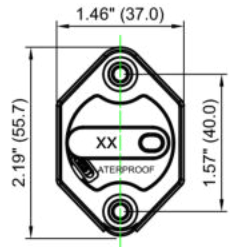
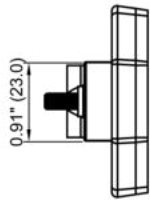
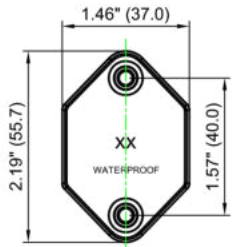
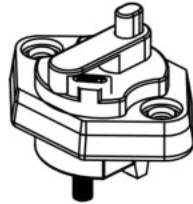
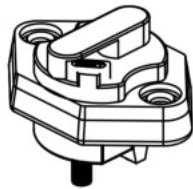
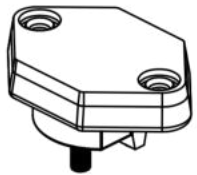

inch (mm)

mount by A

mount by B

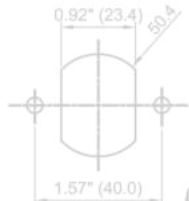

panel cut-out

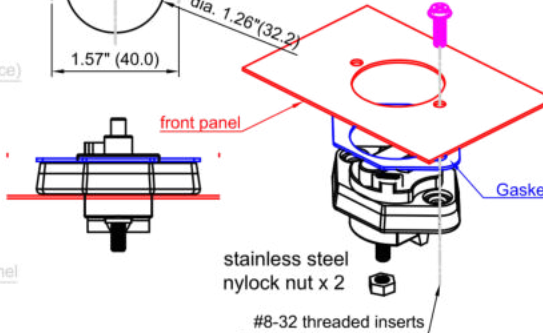
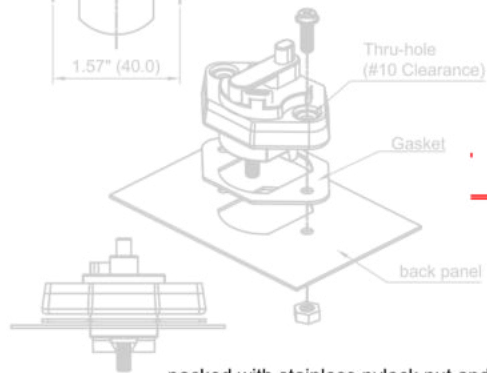
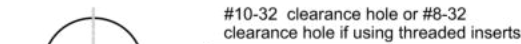

packed with stainless nylock nut and gasket, but not include mounting screw

AEV	Item	Date	Description	Revised By	Remark
-----	------	------	-------------	------------	--------

5      
 model code hold current mounting holes

A: Thru-hole  
(#10 Clearance)  
B: #8-32  
Threaded inserts

**\* Single pole, thermal type breakers**

**\* Rating:** 10-50A T3(54,55) @ 32Vdc ,  
10-30A T1(51) @ 30Vdc, 40-50A T1(51) @ 24Vdc  
(consult to factory for 70A or special requirement)

**\* Interrupt Capacity:** 3KA@32Vdc, per SAE & ABYC E-11

**\* Ingress Protection rating:** IP66 (consult to factory for IP67)

**\* Operating temperature:** -40°C to 85°C (-40°F to 185°F )

**\* Storage temperature:** -40°C to 125°C (-40°F to 260°F )

**\* Materials:** Housing is thermal plastic UL rated 94V0.

**\* Marking:** Standard marking includes amp/volt rating, parts no.

**\* Terminal:** #10-32 threaded studs.

**\* Torque rating:** 24in-lb (2.7Nm) max.

**\* Mounting torque rating:** support #8-32 threaded inserts  
or #10 clearance holes. 18in-lb (2.0Nm) max.

\* Type 1 - Automatic reset, rate up to 30A-30Vdc and 50A-24Vdc

\* Type 3 - Manual reset (with switchable), rate up to 32Vdc

Compliance: SAE J553; ABYC E-11; SAE J1171 (Ignition Protected)  
packed with nuts & gasket, but not include mounting screw.

temperature derating curve

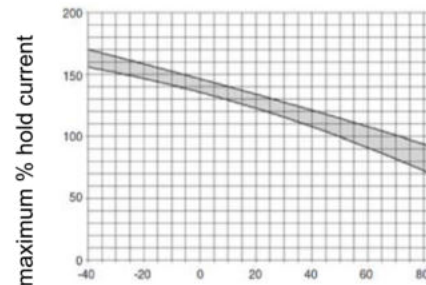

trip time vs. percent of rated current

